







2 RoK

LGH 1053

ca 46,5 m<sup>2</sup>

Detta är en genomgående, ljus och välplanerad lägenhet med en planlösning som kan varieras från 1-2 Rum och kök. Vardagsrummet är avdelat mot köket, men rummen behåller kontakten genom att köksbänken vetter mot både vardagsrum och kök.

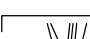
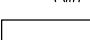
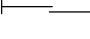



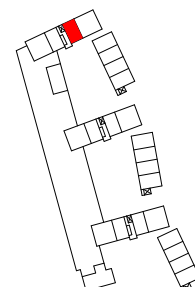
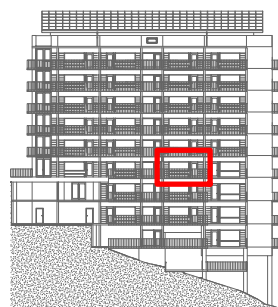
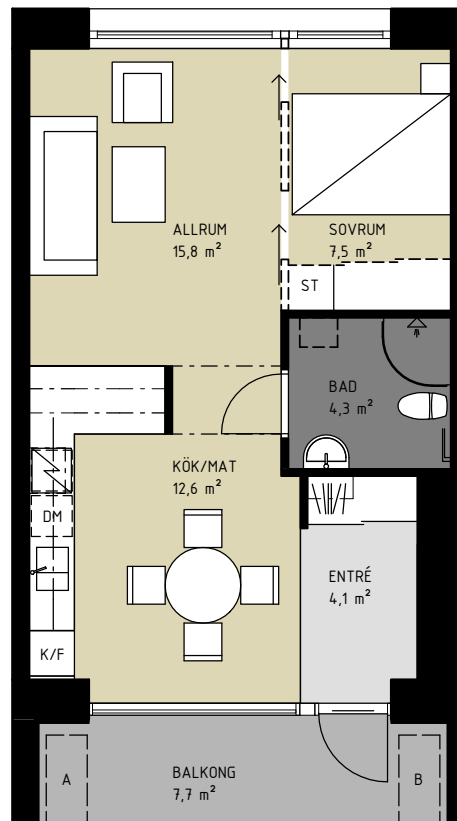

(För alternativ planlösning se bilaga C)

-  PARKETT
-  KLINKER
-  TEXTIL
-  BALKONG OCH DEL AV BALKONG SOM TILLHÖR LÄGENHETEN
-  KAPPHYLLA
-  SKJUTDÖRRS-GARDEROB
-  FRÅNVALSVÄGG
-  TILLVAL
-  TILLVAL HANDDUKSTORK
-  TILLVAL FÖRVARINGSSKÅP





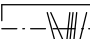
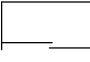
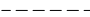
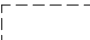
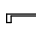



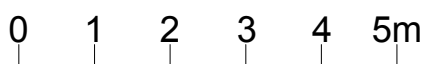
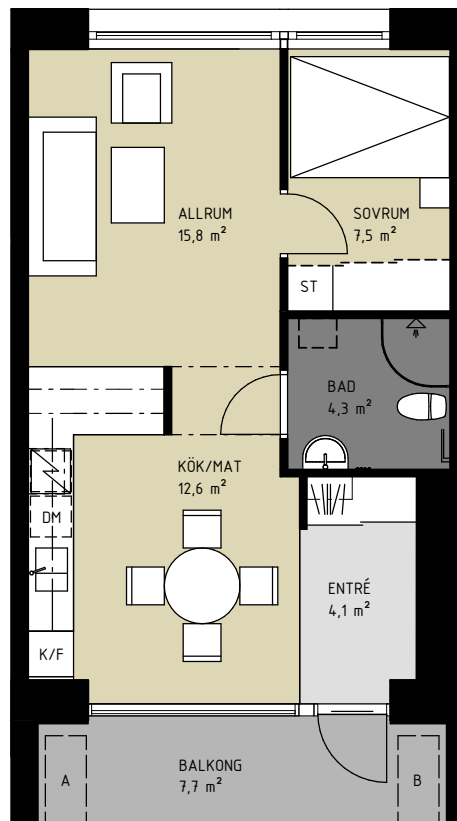



0 1 2 3 4 5m

**Bilaga C, 2 RoK**

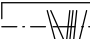
-  PARKETT
-  KLINKER
-  TEXTIL
-  BALKONG OCH DEL AV BALKONG SOM TILLHÖR LÄGENHETEN
-  KAPPHYLLA
-  SKJUTDÖRRS-GARDEROB
-  FRÄNVALSVÄGG
-  TILLVAL
-  TILLVAL HANDDUKSTORK
-  TILLVAL FÖRVARINGSSKÅP

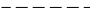

**Bilaga C, 1 RoK**

-  PARKETT
-  KLINKER
-  TEXTIL
-  BALKONG OCH DEL AV BALKONG SOM TILLHÖR LÄGENHETEN
-  KAPPHYLLA
-  SKJUTDÖRRS-GARDEROB
-  FRÄNVALSVÄGG
-  TILLVAL
-  TILLVAL HANDDUKSTORK
-  TILLVAL FÖRVARINGSSKÅP

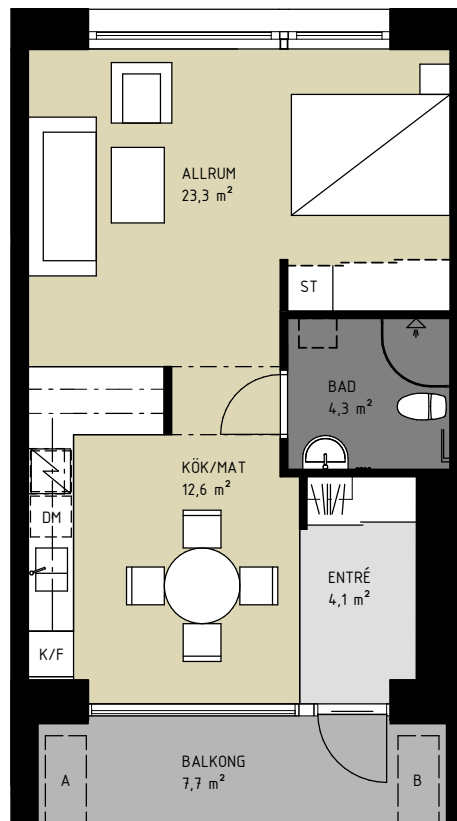

0 1 2 3 4 5m